

# Drawer Unit

## Assembly Instructions

- Take great care handling and lifting parcels
- Open parcels with care to avoid damage
- Check the label to see the contents of each parcel
- If you have ordered several items, keep it simple: only unpack one item at a time
- Use the the Parts Diagram sheet to identify and distinguish between parts
- Any questions: call us on **01227 833333**, or email **sales@jali.co.uk**

### YOU WILL NEED

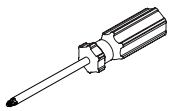

5mm Pozi  
Screwdriver

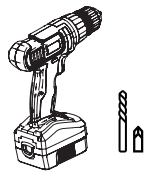

Power Drill +  
2mm Drill Bit  
& Pozi Drive

### EXTRA

- You must fix your product safely in place. Depending on your situation, you may choose to use a drill, suitable screws and wall plugs
- You may wish to use Wood Glue to fix skirting in place
- To ensure a perfect fit with your room skirting board, you may use a saw to scribe the relevant parts during assembly

### FIXINGS INCLUDED

Plus Drawer Handles with Bolts as required

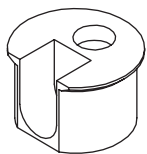

White Cam

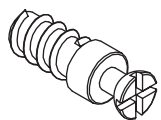

Cam Bolt

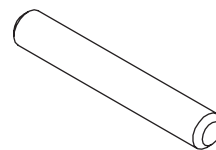

Dowel

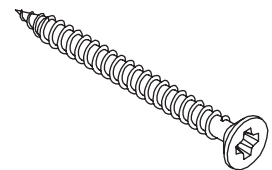

40mm CSK  
Screw

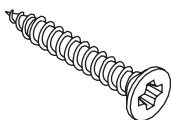

25mm CSK  
Screw

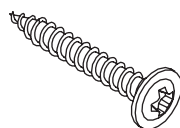

25mm WSH  
Screw

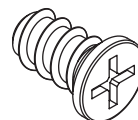

Varianta  
Screw

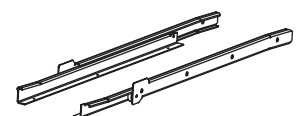

Drawer  
Runners

## HOW DO CAM & BOLTS WORK?

---

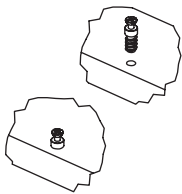

1. Screw in the Cam Bolt, up to the shoulder, into the 5mm hole in one part.

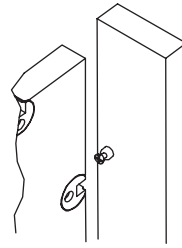

3. Push the two parts together, so that the Cam Bolts disappear into the middle of the Cams.

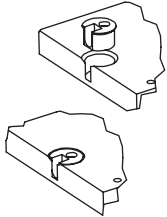

2. Push the Cam, facing outwards, into the corresponding hole on the other part.

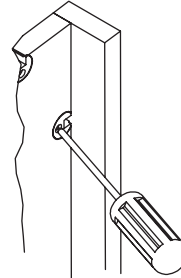

4. Insert a 5mm Pozi screwdriver – tilt back at a slight angle – and rotate CW to lock the Cam.

## PLACE FIXINGS

---

Place White Cams in the holes in the Base Shelf, the Sides and the Straps. If your design includes more than one section, place them in any Mid Dividers too.

Screw Cam Bolts into the Sides and, if your design features skirting, the Front Skirting. If your design includes more than one section, screw Cam Bolts into the Straps, but **on the opposite side** to the White Cams. These holes are through holes so may be easily confused.

Locate the LH and RH Sides. These include an array of holes for the Drawer Runners. The front of the Sides is the flat edge, opposite the groove.

Align the C Shaped Drawer Runners to the Side holes, 25mm back from the front edge. The wheel goes toward the front and down. Attach the runners to the Sides with Varianta Screws.

If your design features any Mid Dividers, you will need to attach the C Shaped Drawer Runners to these too. Be sure to get them the right way round.

## ASSEMBLY

---

Connect the LH Side and Base Shelf by aligning and locking together the Cams and Cam Bolts. The LH Side groove is towards the back. If your design features more than one section, the Base Shelf will include at least one slot, which should be towards the back. The Base Shelf Cams should face downwards.

Put the assembly on the floor, face down, with the groove upwards.

If your design features any Mid Dividers, slot them all the way into the Base Shelf so they align. Now you can fix the RH Side in place using the Cams and Cam Bolts.

Attach the Straps to the top of the assembly by locking the Cams with the Cam Bolts on either Side. The White Cams on the Straps should be facing outwards (upwards, once the unit is upright). If your design features any Mid Dividers, the Strap Cam Bolts should lock into place with the Mid Divider Cams.

Fix the Back in place with the 25mm WSH Screws. Ensure that the top edge is flush with the top of the Sides and Straps.

You can now lift the unit upright. Be careful; it might be heavier than you think!

Place Dowels into the 6mm holes in the Straps. Locate the Top with the Dowels, then fix it in place with Screws through the Straps from beneath. If your Top is 30mm, use 40mm Screws. If your Top is 18mm, use 25mm Screws.

If your design features skirting, you can fix the Front Skirting in place by reaching underneath and locking the Cams to the Cam Bolts in the Sides (and any Mid Dividers). The LH and RH Skirts can be screwed in place from the inside with 25mm CSK Screws, or simply glued.

Depending on packing, we may have assembled (or part assembled) the drawers themselves. You may need to attach the Drawer Fronts with Cams and Cam Bolts.

When the drawer assembly is complete, push the drawers into the unit Drawer Runners, starting at the bottom and working upwards.

**AND YOU'RE DONE!**

#jali #drawers #makeityours